

# FUTURA system



**FUTURA HAND** - Una rivoluzione nel campo dei bloccanti. Dimensioni ridotte ed ergonomia sorprendente in soli 125g!

**FUTURA BODY** - Bloccante ventrale di dimensioni e peso incredibilmente ridotti, solo 80g!

**FUTURA FOOT** - Bloccante supplementare da piede dotato di staffa anti-torsione.

**FUTURA SYSTEM** - E' il logico connubio di tre attrezzi migliorativi che permette di procedere con un'estrema facilità nella tecnica "alternata", come se si fosse su una scala a pioli!

Test condotti da speleologi confermano un guadagno minimo del 30% dell'efficacia di risalita.



EN 567	[ø 8÷12]
NFPA-L	[ø 10÷11]
1983:06	
<b>ALU ALLOY</b>	
	125 g

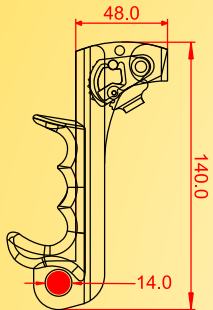

# 876.00.D (RIGHT)  
# 876.00.S (LEFT)  
**FUTURA HAND**

EN 567	[ø 8÷12]
NFPA-L	[ø 11]
1983:06	
<b>ALU ALLOY</b>	
	80 g

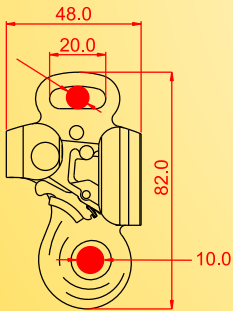

# 824.01  
**FUTURA BODY**

<b>ALU ALLOY</b>	
	130 g

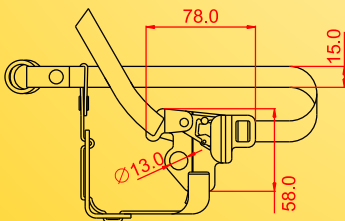

# 876.09.D (RIGHT)  
# 876.09.S (LEFT)  
**FUTURA FOOT**



**SPORT LINE**

**WWW.KONG.IT**

# FUTURA system



**FUTURA HAND** - A revolutionary fall-arrester for its extremely tiny dimensions (only 125g!) and ergonomic shape!

**FUTURA BODY** - Chest ascender incredibly reduced size and weight, only 80g!

**FUTURA FOOT** - Foot ascender to improve and complete the performance of the fall-arrester, equipped with anti-torsion stirrup.

**FUTURA SYSTEM** - It's the natural marriage between three devices, the best support to ascend a rope with the "ROPE WALKING SYSTEM" (as if climbing a ladder). After testing the system, cavers confirm an excellent performance and a 30%-efficiency's increase during the ascent.



EN 567	EN 12841/B	(ø 8÷12)
		(ø 12)
NFPA-L		(ø 10÷11)
1983:06		
ALU ALLOY		125 g

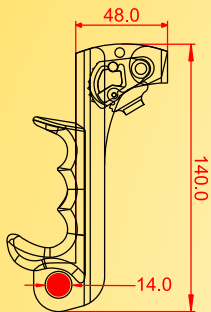

# 876.00.D (RIGHT)  
# 876.00.S (LEFT)  
**FUTURA HAND**

EN 567	EN 12841/B	(ø 8÷12)
		(ø 10÷12)
NFPA-L		(ø 11)
1983:06		
ALU ALLOY		80 g

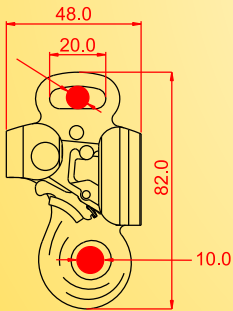

# 824.01  
**FUTURA BODY**

ALU ALLOY	130 g
-----------	-------

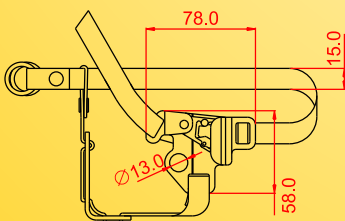

# 876.09.D (RIGHT)  
# 876.09.S (LEFT)  
**FUTURA FOOT**



**SPORT LINE**

**WWW.KONG.IT**

# FUTURA system



**FUTURA HAND** - Une révolution dans le monde des bloqueurs. Dimensions réduites et ergonomie surprenante, dans seulement 125g !

**FUTURA BODY** - Bloquant ventral de petites dimensions et le poids, seulement 80g!

**FUTURA FOOT** - Bloqueur supplémentaire de pied doté d'un étrier anti-torsion.

**FUTURA SYSTEM** - Est la combinaison logique de trois appareils évolués vous permettant d'appliquer la technique « alternée » avec une extrême facilité, comme sur une échelle à barreaux ! Des tests menés par des spéléologues ont démontré un gain minimum de 30% d'efficacité de remontée.



EN 567	EN 12841/B	(ø 8÷12)
		(ø 12)
NFPA-L		(ø 10÷11)
1983:06		
ALU ALLOY		125 g

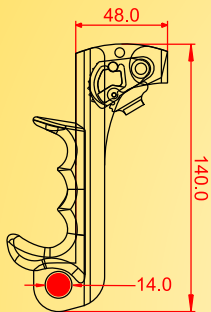

# 876.00.D (RIGHT)  
# 876.00.S (LEFT)  
**FUTURA HAND**

EN 567	EN 12841/B	(ø 8÷12)
		(ø 10÷12)
NFPA-L		(ø 11)
1983:06		
ALU ALLOY		80 g

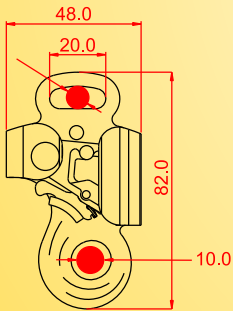

# 824.01  
**FUTURA BODY**

ALU ALLOY	130 g
-----------	-------

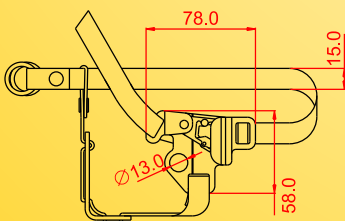

# 876.09.D (RIGHT)  
# 876.09.S (LEFT)  
**FUTURA FOOT**



**SPORT LINE**

**WWW.KONG.IT**

# FUTURA system



**FUTURA HAND** - Eine revolutionäre Steigklemme auch für sehr dünne Seile mit einem Gewicht von nur 125g und einem ergonomischen Design.

**FUTURA BODY** - Sehr kompakte und leichte Brustklemme, nur 80g!

**FUTURA FOOT** - Steigklemme für die Füße um das Absturzsystem zu komplettieren.

**FUTURA SYSTEM** - eine Verbindung von drei Geräten, gibt optimale Hilfe beim Aufsteigen am Seil. Beim Testen durch Höhlenforscher wurde eine 30%ige Reduzierung der Zeit und des Kraftaufwands festgestellt.



EN 567	(ø 8÷12)
EN 12841/B	(ø 12)
NFPA-L	
1983:06	(ø 10÷11)
<b>ALU ALLOY</b>	<b>125 g</b>

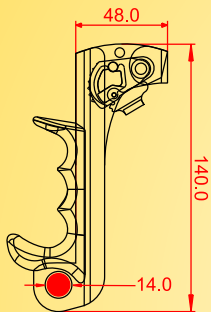

# 876.00.D (RIGHT)  
# 876.00.S (LEFT)  
**FUTURA HAND**

EN 567	(ø8÷12)
EN 12841/B	(ø10÷12)
NFPA-L	
1983:06	(ø11)
<b>ALU ALLOY</b>	<b>80 g</b>

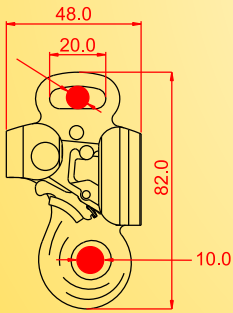

# 824.01  
**FUTURA BODY**

<b>ALU ALLOY</b>	<b>130 g</b>
------------------	--------------

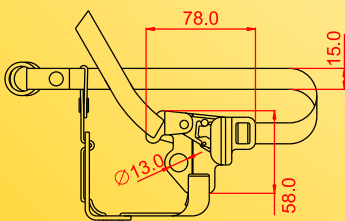

# 876.09.D (RIGHT)  
# 876.09.S (LEFT)  
**FUTURA FOOT**



**SPORT LINE**

**WWW.KONG.IT**