

# FLOWMETER ADJUSTMENT

## How to handle the flowmeter

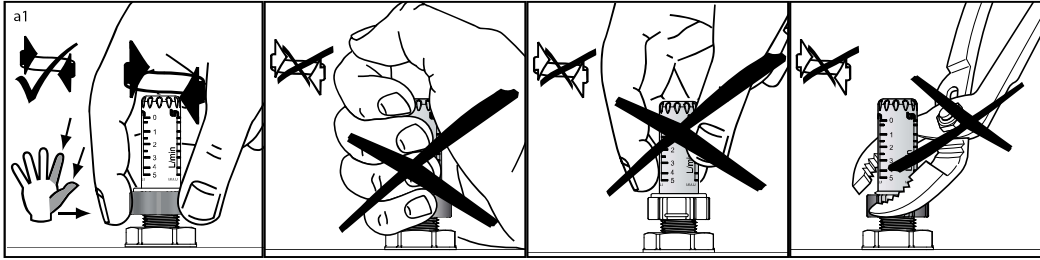

## How to adjust the flow rate

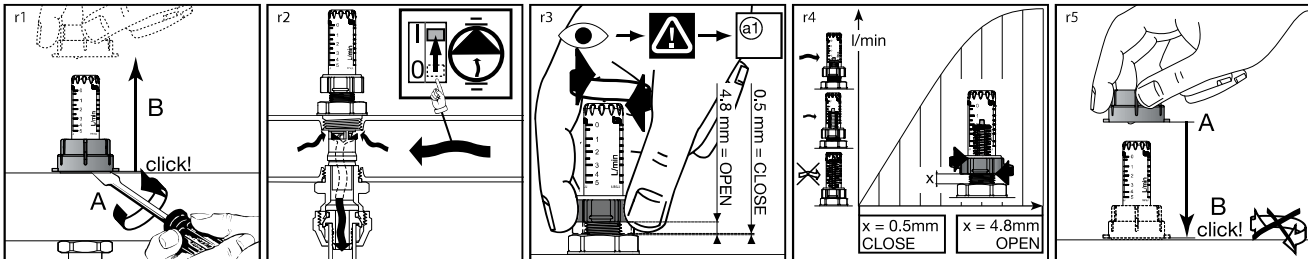

## How to replace the sight glass

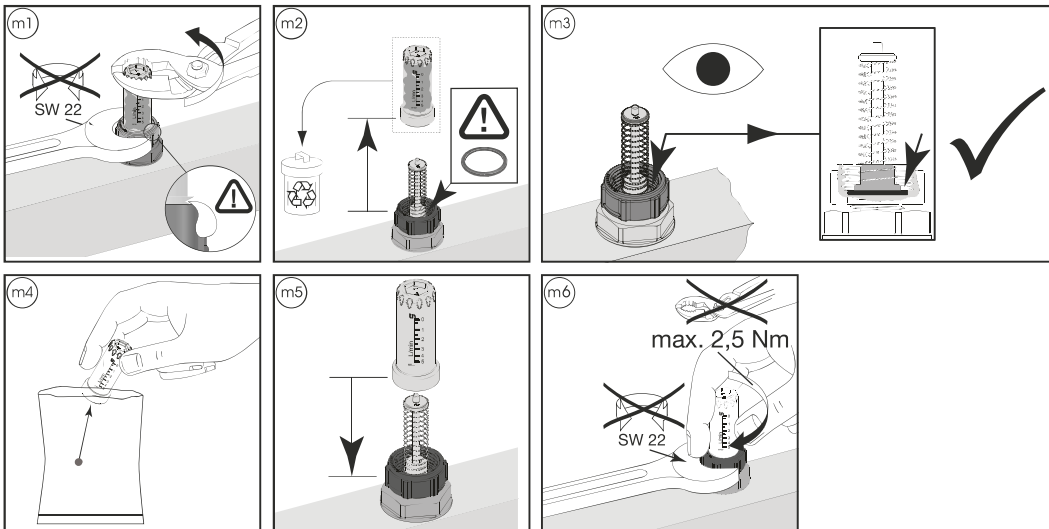

## LOCKSHIELD ADJUSTMENT



Starting from a totally closed position, open the lockshield according to the enclosed chart, in order to achieve the desired flow rate. The adjustment has to be done by means of a hexagonal key in the size of 6 mm.

## INSTALLATION OF ELECTROTHERMAL ACTUATOR



Electrothermal actuator Art. 891M:

- Normally closed, on-off operation.
- Power supply voltage: 230V.
- Power consumption: 1W.
- Minimum and maximum working ambient temperatures: 0°C, 60°C.
- Maximum differential pressure: 1,5bar.
- Length of the power supply cable: m.1.
- Class of protection IP54.
- Available with 2 cables or 4 cables with an auxiliary microswitch.
- Capacity of the auxiliary connection: 300mA.
- CE marked.

## NOTES

-----

-----

-----

-----

-----

-----

-----

-----

-----

We reserve the right to make improvements and changes to the products described herein and to the relative technical data, at any time and without forewarning.



# DIAGRAMS

Below are the flow rate / pressure drop diagrams relative to pre-assembled manifolds with main 1" connections.

## Diagram of flow meter fully open (flow manifold)

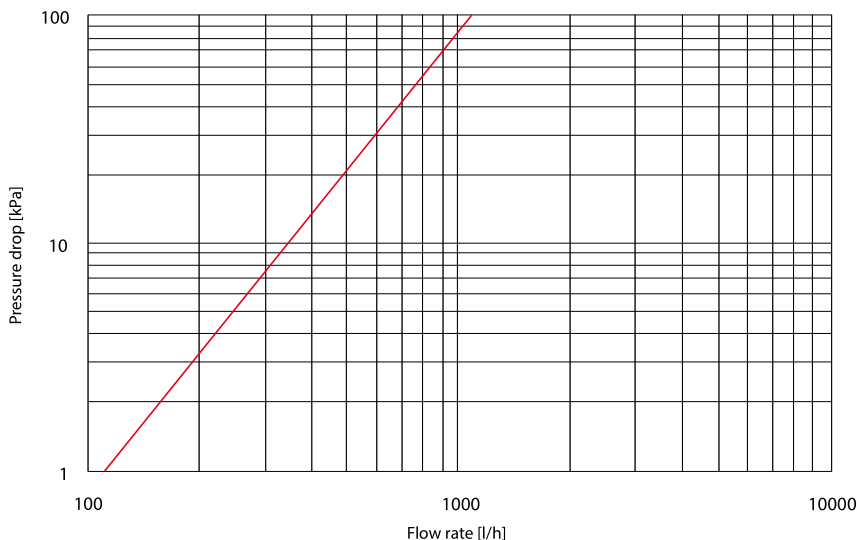

**Kv = 1,1 m<sup>3</sup>/h**

## Regulation lockshield diagram (flow manifold)

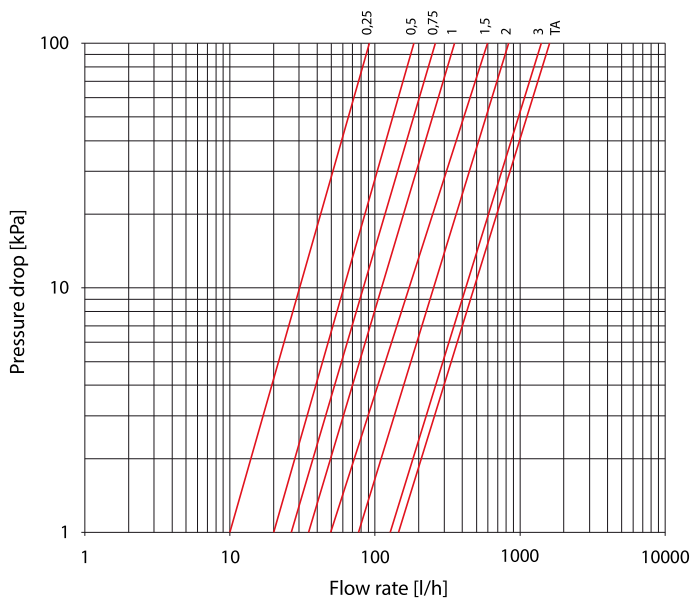

Regulation (rpm)	Kv [m <sup>3</sup> /h]
0,25	0,09
0,5	0,19
0,75	0,27
1	0,36
1,5	0,60
2	0,83
3	1,45
TA (open)	1,65

## Cut-off valve (return manifold)

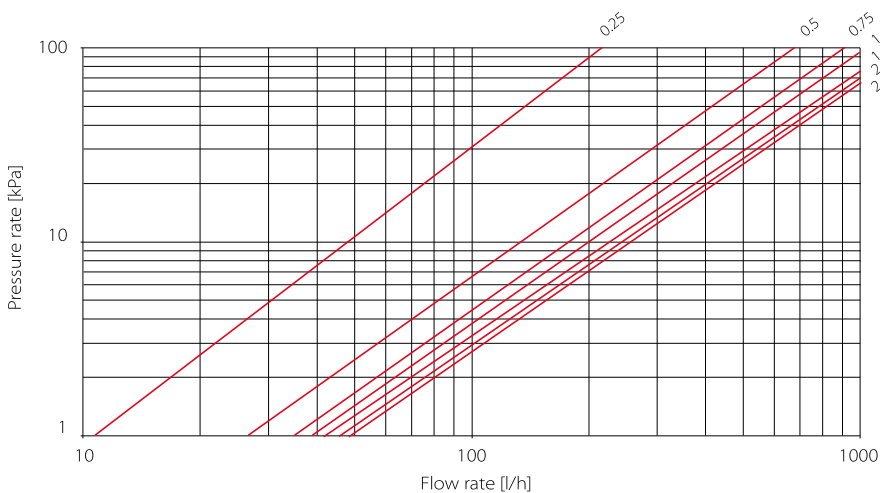

Regulation (rpm)	Kv [m <sup>3</sup> /h]
0,25	0,22
0,5	0,68
0,75	0,91
1	1,05
1,5	1,22
2	1,30
2,5	1,35