

FLOWMETER ADJUSTMENT

How to handle the flowmeter

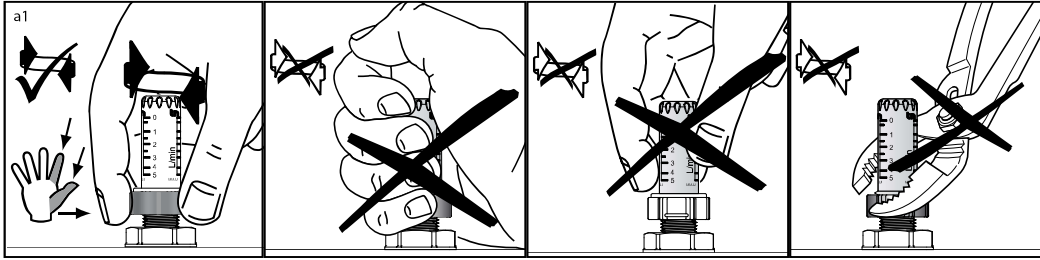

How to adjust the flow rate

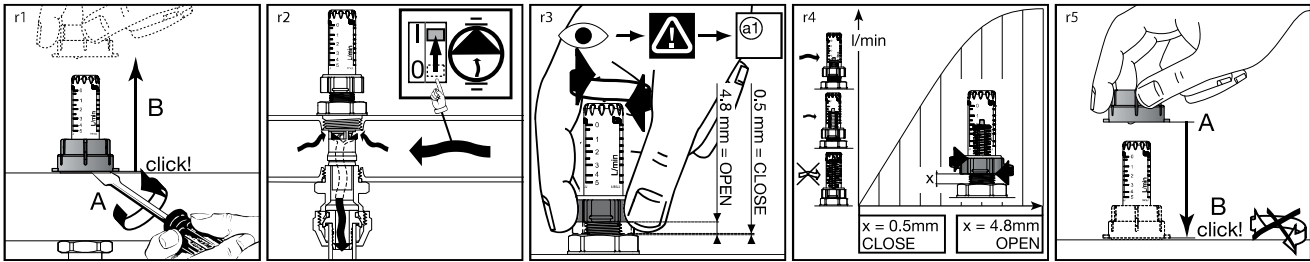

How to replace the sight glass

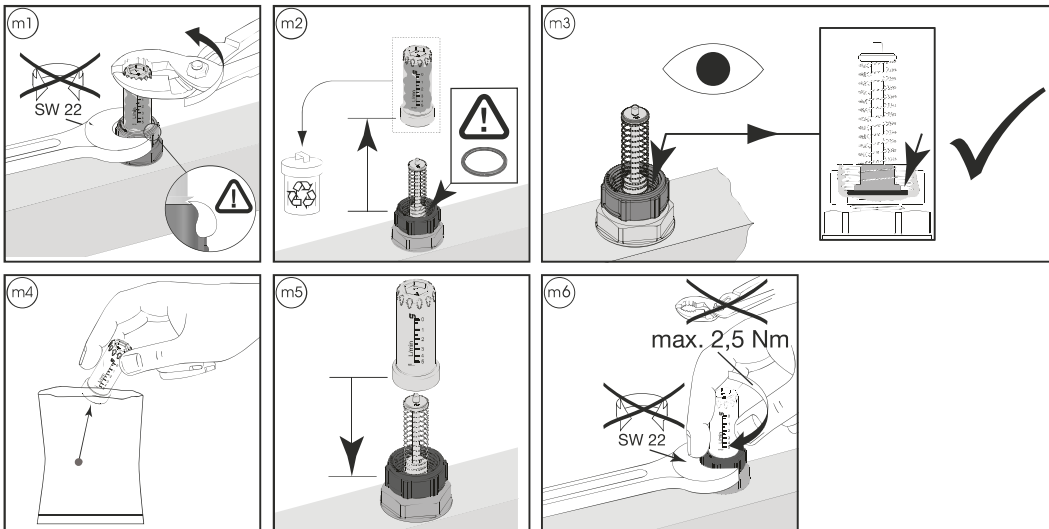

LOCKSHIELD ADJUSTMENT

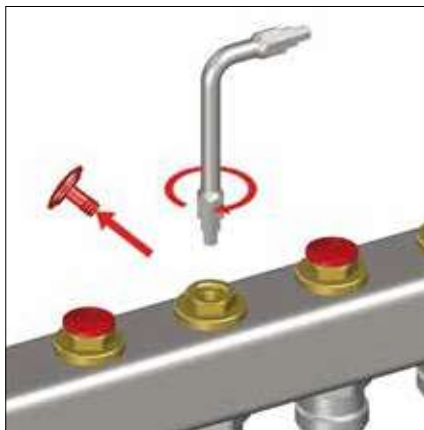

Starting from a totally closed position, open the lockshield according to the enclosed chart, in order to achieve the desired flow rate. The adjustment has to be done by means of a hexagonal key in the size of 6 mm.

INSTALLATION OF ELECTROTHERMAL ACTUATOR

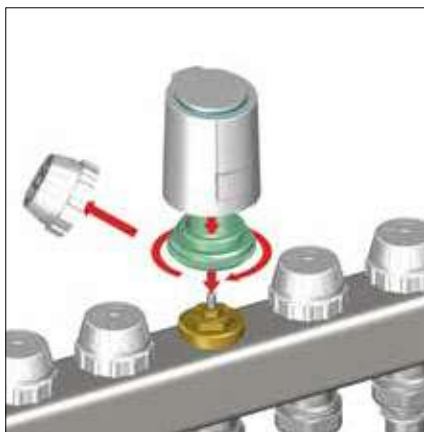

Electrothermal actuator Art. 891M:

- Normally closed, on-off operation.
- Power supply voltage: 230V.
- Power consumption: 1W.
- Minimum and maximum working ambient temperatures: 0°C, 60°C.
- Maximum differential pressure: 1,5bar.
- Length of the power supply cable: m.1.
- Class of protection IP54.
- Available with 2 cables or 4 cables with an auxiliary microswitch.
- Capacity of the auxiliary connection: 300mA.
- CE marked.

NOTES

We reserve the right to make improvements and changes to the products described herein and to the relative technical data, at any time and without forewarning.



DIAGRAMS

Below are the flow rate / pressure drop diagrams relative to pre-assembled manifolds with main 1" connections.

Diagram of flow meter fully open (flow manifold)

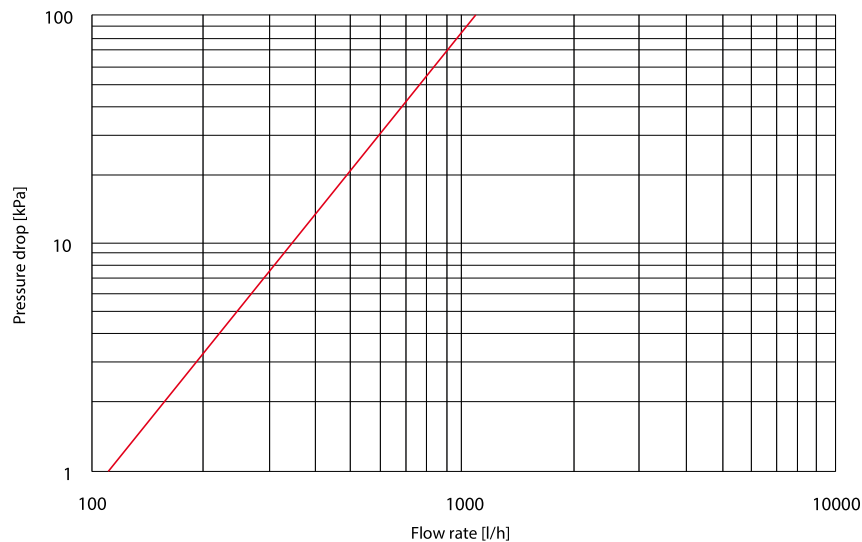

$K_v = 1,1 \text{ m}^3/\text{h}$

Regulation lockshield diagram (flow manifold)

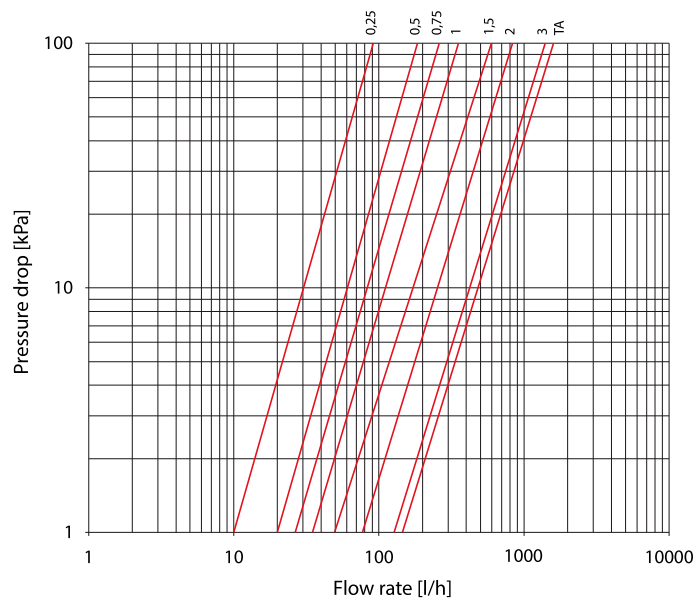

Regulation (rpm)	K_v [m^3/h]
0,25	0,09
0,5	0,19
0,75	0,27
1	0,36
1,5	0,60
2	0,83
3	1,45
TA (open)	1,65

Cut-off valve (return manifold)

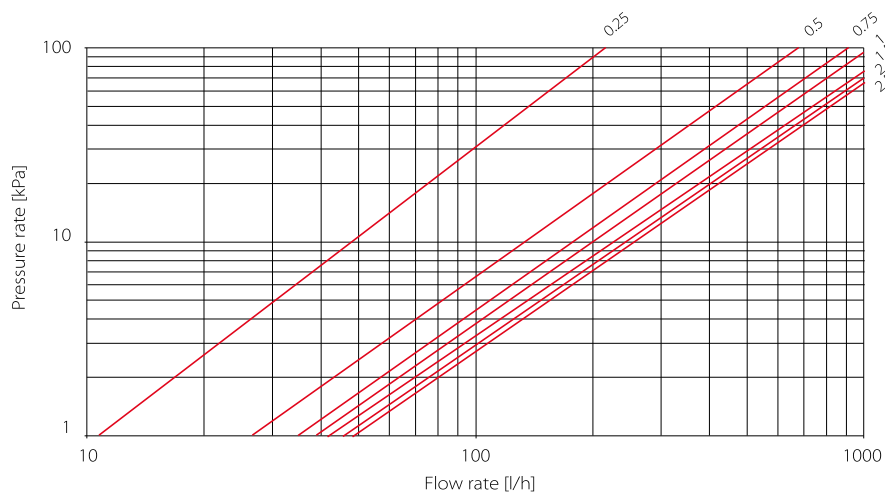

Regulation (rpm)	K_v [m^3/h]
0,25	0,22
0,5	0,68
0,75	0,91
1	1,05
1,5	1,22
2	1,30
2,5	1,35